

V:\VOLUMES\BENCH\400 - PROJECTS\2021\21-026\_COWK\_CASALOMA\DWG\400 - PRODUCTION\01-DETAILS\01-CURRENT\01-01-026\_COWK\_CASALOMA\DWG\400 - MATERIALS PLAN.DWG

**MATERIALS NOTES:**

- A ROOT BARRIER:**  
SUPPLY AND INSTALL ROOT BARRIER IN ALL SITUATIONS WHERE TREES ARE PLANTED WITHIN 15m OF ADJACENT HARD LANDSCAPING. THE ROOT BARRIER SHALL EXTEND A MIN. OF 15m BEYOND EACH SIDE OF THE TRUNK.
- C EXPANSION JOINTS:**  
INSTALL EXPANSION JOINTS AT MAX. 10m SPACING, UNLESS OTHERWISE NOTED AND BETWEEN CONCRETE FLATWORK AND WALLS, CURBS, AND EXISTING FLATWORK OR STRUCTURES. SEE EXPANSION JOINT DETAILS FOR ADDITIONAL INFORMATION.
- D CONTROL JOINTS:**  
INSTALL CONTROL JOINTS IN ALL OTHER LOCATIONS THAT DO NOT REQUIRE EXPANSION JOINTS. CONTROL JOINTS TO BE CLEAN, STRAIGHT AND PERPENDICULAR TO THE EDGE OF PAVEMENT. SEE CONTROL JOINT DETAILS FOR ADDITIONAL INFORMATION.
- E SITE FURNISHINGS:**  
SUPPLY AND INSTALL ALL SITE FURNISHINGS AS FOLLOWS AND AS PER MANUFACTURERS' SPECIFICATIONS.  

BIKE BACKS:	SURFACE MOUNT
WOOD BENCH:	SURFACE MOUNT
REGULAR PICNIC TABLES:	SURFACE MOUNT
ACCESSIBLE PICNIC TABLES:	SURFACE MOUNT

**MATERIALS LEGEND:**

<p><b>1</b>  ASPHALT MILLINGS C/W WHITE LINE PAINTING - LOADING ZONE MARKINGS, 15 MILS ACRYLIC ROADWAY PAINT, 10cm WIDE LINES AT 0.5m O.C.</p> <p><b>2</b>  C.I.P. CONCRETE PAVING COLOUR: NATURAL FINISH: BROWN</p> <p><b>7</b>  OPTIONAL UNIT PAVING - TYPE 1 PRODUCT: BARKMAN ROMAN PAVES SUPPLIER: BURINCO (250-769-3285) SIZE: 210 x 315 x 60mm; 210 x 262.5 x 60mm; 210 x 157.5 x 60mm; 210 x 105 x 60mm; COLOUR: SIERRA GREY</p> <p><b>7</b>  OPTIONAL UNIT PAVING - TYPE 2 PRODUCT: BARKMAN ROMAN PAVES SUPPLIER: BURINCO (250-769-3285) SIZE: 210 x 315 x 60mm; 210 x 262.5 x 60mm; 210 x 157.5 x 60mm; 210 x 105 x 60mm; COLOUR: ANTIQUE BROWN</p> <p><b>1</b>  BOARDWALK</p> <p><b>PS</b>  COMPACTED CRUSHER CHIP OVER EXISTING GRAVEL SURFACE PRODUCT: 10mm CRUSHER CHIPS SUPPLIER: BURINCO (250-769-3285) OR PRE-APPROVED EQUAL</p> <p><b>3</b>  COMPACTED CRUSHER CHIP OVER GRANULAR BASE PRODUCT: 10mm CRUSHER CHIPS SUPPLIER: BURINCO (250-769-3285) OR PRE-APPROVED EQUAL</p>	<p><b>M1</b>  IMPORTED SAND PRODUCT: 3mm WASHED SAND SUPPLIER: BURINCO (250-769-3285) OR PRE-APPROVED EQUAL</p> <p><b>M2</b>  GRAVEL PRODUCT: 25mm DRAIN ROCK SUPPLIER: BURINCO (250-769-3285) OR PRE-APPROVED EQUAL</p> <p><b>M3</b>  COMPOST MULCH GLENNHOSE GROW, OR PRE-APPROVED EQUAL</p> <p> EXISTING CONCRETE PAVING</p> <p> EXISTING AGGREGATE PAVING</p> <p> EXISTING SANDY GRAVEL BEACH</p>	<p><b>GENERAL LEGEND:</b></p> <p> EX. CONIFEROUS TREE TO REMAIN</p> <p> PROPOSED DECIDUOUS TREE (SEE PLANTING PLAN)</p> <p> ROOT BARRIER PRODUCT: DEEP ROOT UB-24, AVAILABLE FROM PRO-SOURCE IRRIGATION SUPPLY (250.682.9424) INSTALLED PER MNF. SPEC. CONTINUOUSLY IN LOCATIONS SHOWN ON PLAN</p>
--	---	--

**FURNISHINGS LEGEND:**

<p> BIKE RACK PRODUCT: MAGLIN 2300 SERIES ICONIC BIKE RACKS MFR: 2300-0000 MNF: MAGLIN (1-800-716-5506) SIZE: 673x520x51mm FINISH: POWDERCOATED FINE TEXTURED BLACK INSTALL: SURFACE MOUNTED AS PER MNF. SPEC.</p> <p> OWNER SUPPLIED TRASH RECEPTACLE PRODUCT: Co/WK 5hrd. INSTALL: SURFACE MOUNTED</p> <p> OWNER SUPPLIED WOOD BENCH PRODUCT: WISHBONE RUTHERFORD PARK BENCH - ANGLED LEG; MODEL#: RAL-6 MNF: WISHBONE (1-866-626-0476) SIZE: 1829 x 648 x 876mm FINISH: WOOD - SAND; ALUMINUM FRAME - POWDERCOATD BLACK TEXTURED INSTALL: SURFACE MOUNTED AS PER MNF. SPEC.</p> <p> OWNER SUPPLIED REGULAR PICNIC TABLE (OPTIONAL) PRODUCT: WISHBONE RUTHERFORD PICNIC TABLE MODEL#: RPT-6 MNF: WISHBONE (1-866-626-0476) SIZE: TABLE: 1829 x 727 x 762mm SEAT: 1829 x 283 x 470mm FINISH: WOOD - SAND; ALUMINUM FRAME - POWDERCOATD BLACK TEXTURED INSTALL: SURFACE MOUNTED AS PER MNF. SPEC.</p> <p> OWNER SUPPLIED ACCESSIBLE PICNIC TABLE PRODUCT: WISHBONE RUTHERFORD PICNIC TABLE MODEL#: RPTWC-8 MNF: WISHBONE (1-866-626-0476) SIZE: TABLE: 2438 x 727 x 762mm SEAT: 1829 x 283 x 470mm FINISH: WOOD - SAND; ALUMINUM FRAME - POWDERCOATD BLACK TEXTURED INSTALL: SURFACE MOUNTED AS PER MNF. SPEC.</p>	<p><b>REVISIONS / ISSUES:</b></p> <table border="1" style="width: 100%; border-collapse: collapse;"> <thead> <tr> <th>NO.</th> <th>DATE</th> <th>DESCRIPTION</th> </tr> </thead> <tbody> <tr> <td>3</td> <td>05/01</td> <td>ISSUED FOR RFP</td> </tr> <tr> <td>2</td> <td>03/07</td> <td>ISSUED FOR 90% REVIEW</td> </tr> <tr> <td>1</td> <td>03/07</td> <td>ISSUED FOR 70% REVIEW</td> </tr> <tr> <td>1</td> <td>12/21</td> <td>ISSUED FOR 70% REVIEW</td> </tr> </tbody> </table>	NO.	DATE	DESCRIPTION	3	05/01	ISSUED FOR RFP	2	03/07	ISSUED FOR 90% REVIEW	1	03/07	ISSUED FOR 70% REVIEW	1	12/21	ISSUED FOR 70% REVIEW
NO.	DATE	DESCRIPTION														
3	05/01	ISSUED FOR RFP														
2	03/07	ISSUED FOR 90% REVIEW														
1	03/07	ISSUED FOR 70% REVIEW														
1	12/21	ISSUED FOR 70% REVIEW														



**NOT FOR CONSTRUCTION**

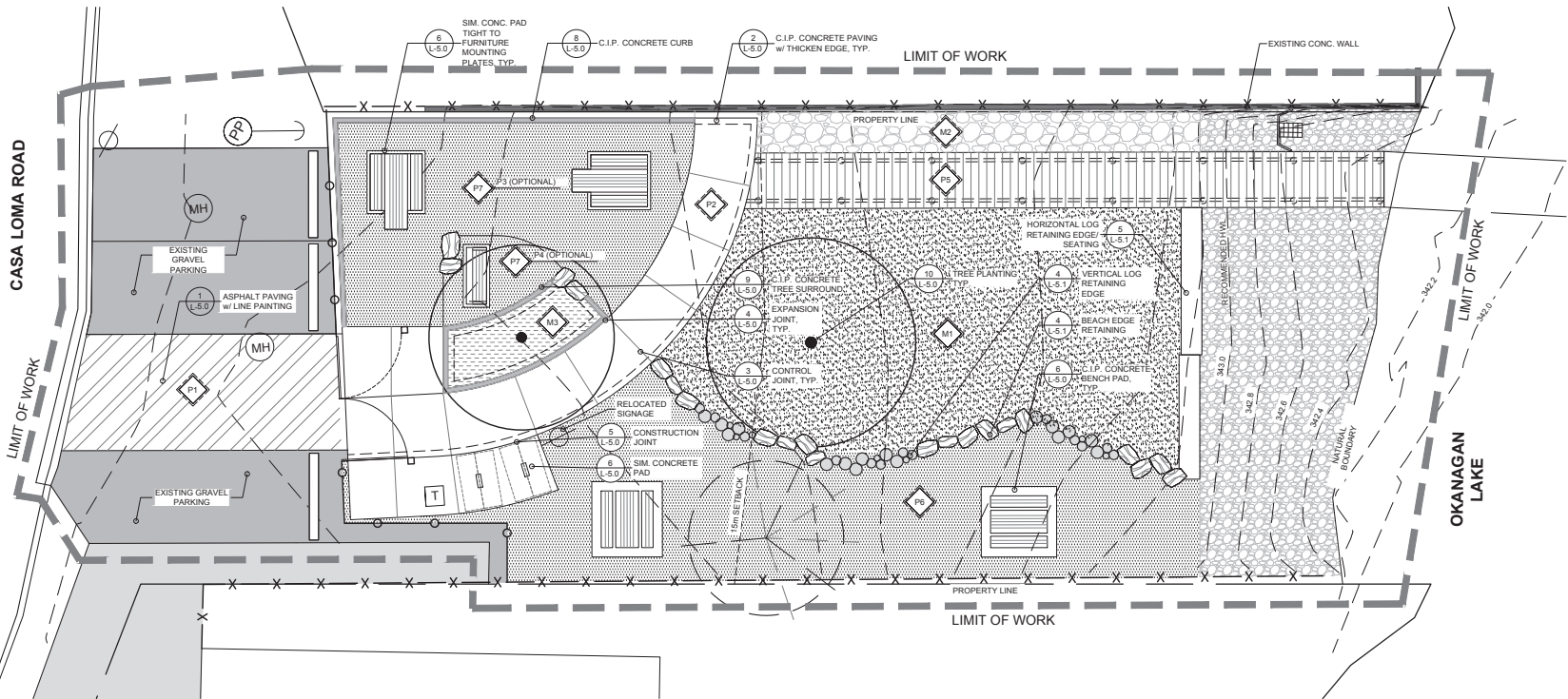

PROPERTY OF BENCH SITE DESIGN INC. NO. CANNOT BE USED WITHOUT THE OWNER'S WRITTEN CONSENT. COPYRIGHT RESERVED. THIS DRAWING AND DESIGN IS AT ALL TIMES BE REVISIONS / ISSUES:

NO.	DATE	DESCRIPTION
3	05/01	ISSUED FOR RFP
2	03/07	ISSUED FOR 90% REVIEW
1	03/07	ISSUED FOR 70% REVIEW
1	12/21	ISSUED FOR 70% REVIEW



CLIENT:  
CITY OF WEST KELOWNA  
WEST KELOWNA, B.C.

PROJECT:  
COWK CASA LOMA  
DOCK PARK  
WEST KELOWNA, B.C.

SHEET TITLE:  
MATERIALS  
PLAN

DESIGN BY:	CLB/BYY
DRAWN BY:	YY
CHECKED BY:	KN
PROJECT NO.:	21-008
SCALE:	1:75

SHEET NO.:

**L-3.0**